

Sabre 42

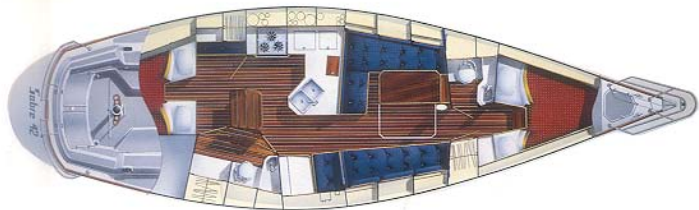

ELEGANT FLAGSHIP



SABRE 42 SPECIFICATIONS

L.O.A.....	41'9"
L.W.L.....	34'0"
Beam.....	12'8"
Draft:	
External Lead Fin Keel.....	6'10"
Optional Keel/CB.....	4'9"/8'6"
Displacement:	
Keel Model.....	18,800 lbs.
Keel/CB.....	19,200 lbs.
Ballast:	
Keel Model.....	7,800 lbs.
CB.....	8,200 lbs.
Sail Area.....	755 sq.ft.
Cockpit Length.....	8'9"
Headroom.....	6'5"
Westerbeke (HP).....	46
Water Tank.....	120 gal.
Holding Tank.....	55 gal.
Batteries (No./Amphour).....	3/100
Berths (No.-Size).....	7-6'6"
Hatches.....	9
Dorades.....	4
Opening Ports.....	12

Designed by: The Sabre Design Team.
 (Some optional equipment is shown and all specifications are approximate.)

Sabre Yachts



STRENGTH AND DURABILITY

Extensive laboratory testing has produced the advanced fiberglass materials and techniques used in the construction of the Sabre 42.

The Sabre 42 stands up to the demands of the sea. Her hull is balsa cored, hand laminated fiberglass utilizing vinyl ester resin. Additional fiberglass and resin reinforcements are used in high stress areas for added durability.

The deck is hand laminated fiberglass with balsa core stiffening and offers a repairable nonskid surface. Aluminum backing plates reinforce deck hardware installation. Toerails, handrails, and trim are teak. There is an option of a teak coaming and trim package for an even more luxurious appearance.

Deck hardware and rigging are sturdy and dependable. Welded stainless steel double rail bow pulpit and stern rail, stanchion posts, two gates, plus upper and lower lifelines are provided for your safety. The Rig-Rite mast and boom are aluminum with a tough Awlgrip finish. Inboard genoa tracks are well-positioned for optimum sheeting angles. Her main sheet is led to a Harken traveler on the cabin top. Genoa sheets are led to Schaefer foot blocks and then to Lewmar #52 self-tailing winches.

The interior is handcrafted using teak and mahogany and the most meticulous boatbuilding techniques. Oiled teak, complemented by cypress hull ceilings, is used on most visible wood surfaces. Varnished mahogany is used under the berth cushions and in other concealed areas. All trim, drawer fronts, and locker doors are solid teak for a warm and bright look. The cabin sole is teak and holly.

Optional forward layout features wraparound vanity with sink.

LUXURIOUS ACCOMMODATIONS

Livability aboard the Sabre 42 is defined in terms of privacy, convenience and comfort. An innovative aft cabin arrangement features three separate cabins with berths for seven, and two heads, each with a shower. Standing headroom is 6'5". An optional forward cabin layout features a vanity with sink and a settee in place of the second head.

The number of storage areas and openings on the Sabre 42 illustrates the efficiency of her plan. Storage facilities include 17 drawers, 46 storage and hanging lockers, and 18 shelves. Superb light and ventilation are achieved with 12 opening ports, 9 hatches, and 4 dorado vents.

The expansive main cabin area offers all the amenities of a second home, with plush 6'6" berths port and starboard. A double leaf table folds up against a large magazine rack on the main bulkhead, with a dinette table option available. A complete navigation station is equipped with a chart light, shelving, deep storage bin, three drawers, and a locker.

Roominess and at-home amenities are exceptional in the head. Features include a handcrafted teak grate over the sole, vanity with sink, and a pressurized hot and cold water shower.

Sabre 42

STUNNING ELEGANCE

The Sabre 42 is the ultimate sailing yacht, blending stunning elegance, contemporary styling and sailing ease. Function is brilliantly united with form in her design.

Her list of credentials includes a nomination in 1987 as *Sailing World* magazine's "Boat of the Year" for her size range.

Innovative use of space has produced private living quarters for up to seven crew members. Three cabins, including two luxurious staterooms, each have private access to washrooms.

Sailing characteristics of the Sabre 42 are outstanding. Her well-balanced sail plan, with equal sized foretriangle and main, offers unparalleled ease for a short-handed crew. A powerful hull shape yields excellent performance either on the race course or on the blue water cruise.

DESIGN EXCELLENCE

Powerful performance on the race course and stability in varying sea conditions are the benefits of the Sabre 42's hull shape. The combination of a modern hull configuration and a high aspect, balanced rig, provides for excellent control.

The American Bureau of Shipping (A.B.S.) has approved the structural hull and deck plans of the Sabre 42. The integrity of her design is affirmed by their official rating as an A-1offshore racing yacht.

Contributing to the Sabre 42's handling ease is a strong, well-balanced rig. She has rod rigging for lasting durability and low windage airfoil spreaders for race-winning performance. Internal main and genoa halyards keep lines tangle-free. The boom is equipped with an internal clew out-haul, topping lift, plus two sets of jiffy reefing led aft.

EASY ENTERTAINING

The walk-in port side galley makes entertaining guests a pleasure. As beautiful as it is functional, the galley has bright white countertops outlined in laminated teak. All the conveniences of home are provided by a standard CNG three burner range, double stainless steel sinks, and well insulated icebox including separate freezer and refrigerator compartments. A unique built-in wastebasket and silverware drawer keeps the galley neat and organized.

SABRE CRAFTSMANSHIP

The Sabre 42 is handcrafted with fierce pride by dedicated Maine craftsmen. Precise attention to detail, plus years of research and development, have led to an exceptional level of refinement.

Quality is assured by the Sabre Quality Control Team, a group headed by professional engineers with extensive yachting experience. Over 600 separate quality inspections on each yacht assure the renowned Sabre standard of excellence.

RELIABILITY AT SEA

Mechanical and electrical systems provide all the assurances for safety and reliability at sea. The auxiliary engine, a Westerbeke 46, powers the Sabre 42 at hull speed with ample reserve power.

There are 120 gallons of pressurized hot and cold water accessible in both heads and galley.

Quality fittings and components are found throughout her internal systems. All thru-hull fittings below the waterline are protected by bronze seacocks. A manual bilge pump is recessed into the cockpit wall, and an automatic electric bilge pump is standard.

The Sabre 42 has ample and easy to operate circuit breakers with the 12-volt and 110-volt electrical system. Individual battery charge indicators show each battery's charge condition. Wiring is color coded and installed in accordance with U.S. Coast Guard and A.B.Y.C. standards. Hinged panels are provided in the headliner to facilitate access to the navigational instruments installed in the cockpit face. Navigation lights and a masthead light are installed in accordance with U.S. Coast Guard standards. A radio chair is provided in the mast. The foredeck floodlight and anchor light are standard.

The Westerbeke 46, four cylinder, fresh water cooled, diesel engine is the highest quality auxiliary power available. Tachometer, engine hourmeter, voltmeter, oil, fuel, and temperature gauges are conveniently recessed in the cockpit. The engine room ventilation is provided by a cockpit controlled blower system. A heavy duty aluminum fuel tank assures hours of powering.

COCKPIT CONVENIENCE

The T-shaped 8'9" cockpit is maximized for comfort. It is of a unique design which allows full length, reclining comfort with excellent function. There is good visibility from the raised helmsman's seat, above the 44" wheel.

Three cockpit lockers and one dockline storage bin, plus winch handle pockets, provide convenience under sail. A starboard step-in locker features varnished shelving for sail storage and cruising gear.

